

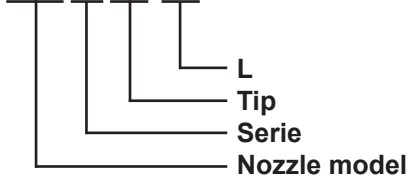

Ref.	L	Lb
RMT26-HN-070	70	50
RMT26-HN-080	80	60
RMT26-HN-090	90	70
RMT26-HN-100	100	80
RMT26-HN-110	110	90
RMT26-HN-120	120	100
RMT26-HN-130	130	110
RMT26-HN-140	140	120
S		
RMT26-HN-290	290	270

CODE FOR ORDER:

RMT 26-HN-100



TECHNICAL SPECIFICATIONS	
Diam.Channel	2.5 mm
Lmin.	70,00mm
Lmax.	290,00mm
Thermocouple	Type J
Torque Wrench	10 mm
Torque	10 N.m
Gate diam.	0.6-0.8mm
Tips	ØD(Pitch)
2	12 ~ 18mm
3	12 ~ 18mm
4	15 ~ 18mm

Viscosity	Material	Shotweight (g)
High	PP, PS, PE...	6
Medium	ABS, POM, SAN...	3
Low	PC, PBT...	-

Note: Shotweight is per tip
For medium and low viscosity applications, please contact Runnertech.

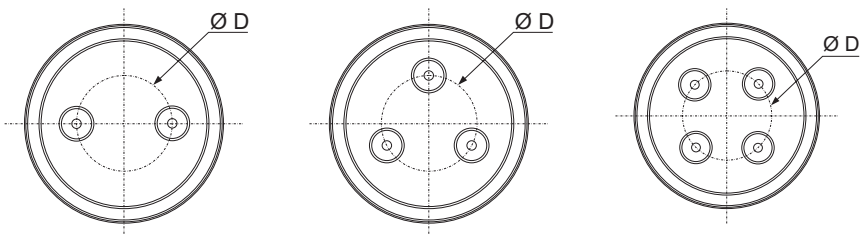

Download your Cad file at www.runner-tech.com